



THANK YOU FOR PURCHASING KOSO DB-02 SPEEDOMETER, BEFORE OPERATING THE UNIT, PLEASE READ THE INSTRUCTION THOROUGHLY AND RETAIN IT FOR THE FUTURE REFERENCE.

Notice

- The meter function is powered by the inner battery, but the back light is powered by the outside power input.
- For installation, please follow the steps described in manual. Any damage caused by wrong installation shall be imputed to the users.
- Don't break or modify the wire terminal. To avoid the short circuit, please don't pull the wire when installing.
- Do not disassemble or change any parts excluding the manual description.
- The interior examination or maintenance should be executed by our professionals.

MARK MEANING:

NOTE You could get the installation details from the information behind the mark.

△ Some processes must be followed to avoid the affection caused by wrong installation.

⚠ WARNING! Some processes must be followed to avoid damages to yourself or the public.

⚠ CAUTION! Some processes must be followed to avoid the damage to the vehicle.

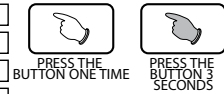

1-1 Accessory

1 LCD meter X 1	2 Power wire X 1	3 RPM WIRE SET (A TYPE) X 1	4 RPM WIRE SET (C TYPE) X 1
5 Temp sensor wire set X 2	6 PT 1/8 water temp sensor X 2	7 Reed switch speed sensor X 1	8 D6 X 5L mm magnet X 1
9 Mid-way connect X 2	10 M8/ S type speed sensor bracket X 1	11 M10/ S type speed sensor bracket X 1	12 M5X5L Hexagon socket screw X 2
13 Battery X 1	14 2.5 mm spanner X 1	15 4 mm spanner X 1	16 Meter bracket X 1
17 M5 washer X 2	18 M5 X 15L screw X 2		

NOTE Please contact the local distributor if the items you open are not the same, with the above-listed one.

1-2 Option accessory

1 Disc magnet screw	2 Oil temp sensor adapter	3 Water temp sensor adapter	4 Temp sensor
5/16-18 X 22.1L M5 X P0.8 X 12L M6 X P1.0 X 12.6L M6 X P1.0 X 19.7L M6 X P1.0 X 24L M8 X P1.25 X 22.5L M8 X P1.25 X 27.5L M8 X P1.25 X 29L M10 X P1.25 X 28.3L	M12 X P1.5 X 15L M14 X P1.25 X 15L M14 X P1.5 X 15L M16 X P1.5 X 15L M18 X P1.5 X 15L M20 X P1.0 X 15L M20 X P1.5 X 15L	M14 M16, M18 M22, M26 mm	M10 X P1.0 M12 X P1.5 M14 X P1.25 M14 X P1.5 M16 X P1.5 / M18 X P1.5
5 L TYPE speed sensor bracket	6 Temp sensor wire set (2 M)		

NOTE Some of the option accessories may not sell. For the details, please contact the local distributor.

2-1 Wiring installation instructions

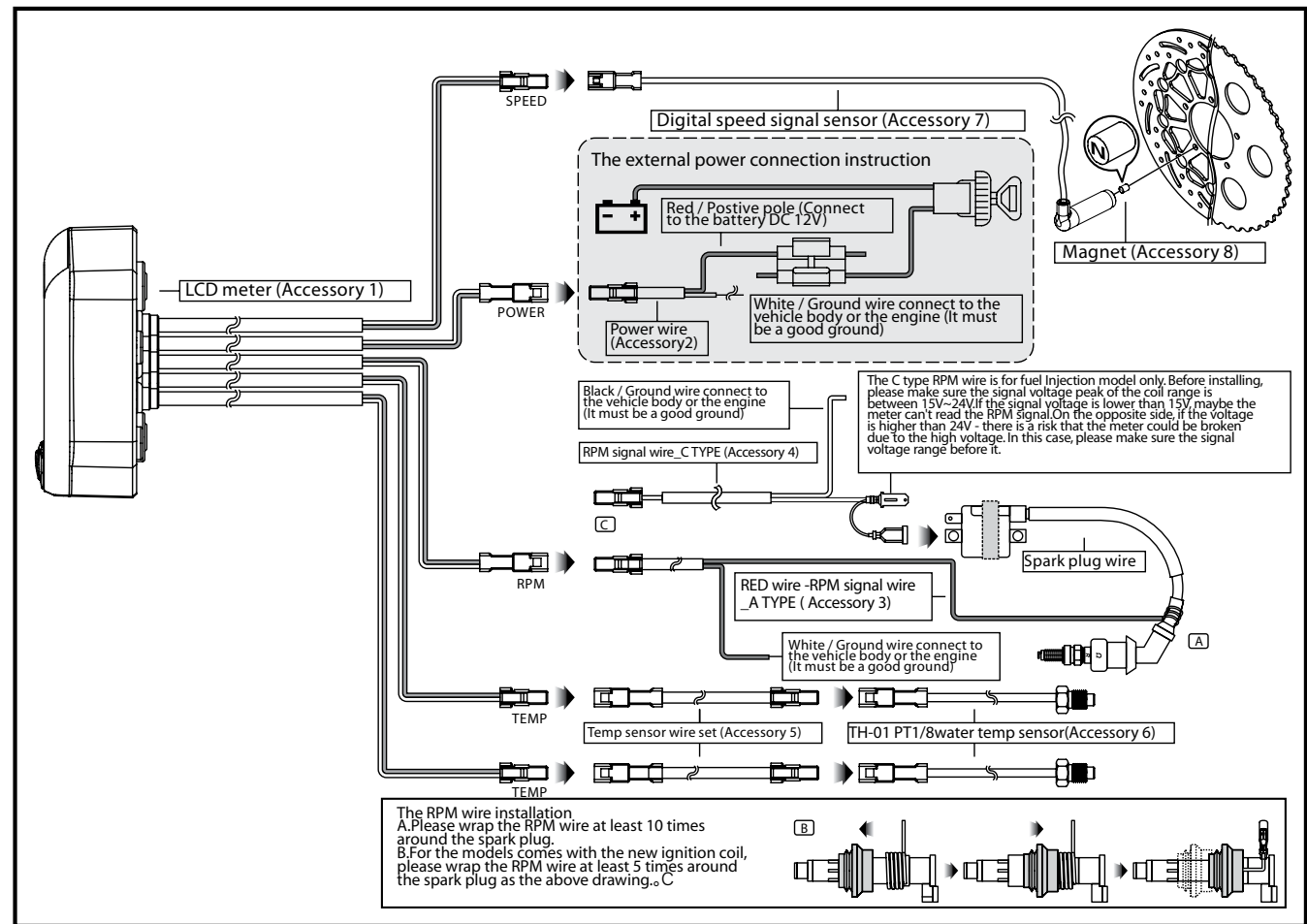

2-2 Battery change

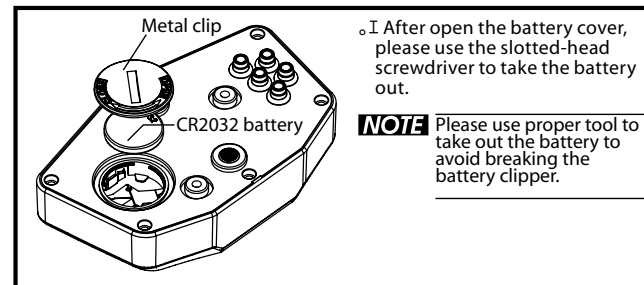

2-3 INSTALLATION INSTRUCTIONS.

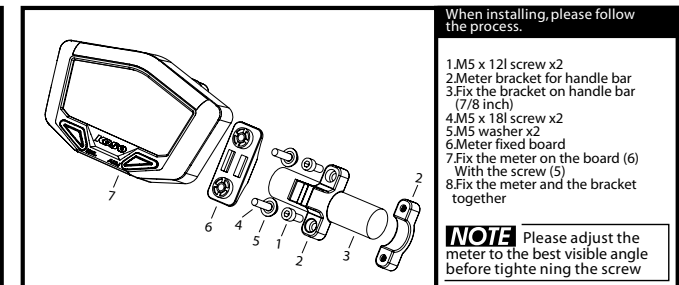

3 Display instruction

The temperature alarm A/B
 Setting range: G60~250°C (140~482°F)
 Setting unit: G1°C (°C) / °F

Speeding warning light
 Setting range: G30~360 km/h (19~225MPH)
 Setting unit: G1 km/h (MPH) / °C

The tachometer bar range
 Display range: G10,000, B15,000
 B20,000 RPM / °C

Batter situation
 When the battery is full, it will show the battery in 4 segments.
 When the external power is connect, the battery symbol will disappear.

Auto sleep function
 When the meter works with the inner battery, it will enter the auto sleep function when the meter idles over 20 seconds

The temperature alarm A/B
 Setting range: G60~250°C (140~482°F)
 Setting unit: G1°C (°C) / °F

CLOCK
 Time: G24H
 When the meter is off, it will show the seconds.

Volt meter,] the external power. ^
 Display range: G0.0~18.0V
 Display unit: G0.1V
 When the external power is connected, it will show the voltage value directly. It will show 0.0V when the external power is disconnected.

3 stages RPM shift light
 Setting range: G5,000~20,000 RPM
 Setting unit: G100 RPM

The digital tachometer
 Display range: G0~360 km/h (0~225 MPH)
 Display unit: G1 km/h (MPH) / °C

Bar graph tachometer
 Display range: G0~20,000 RPM
 Display unit: G10 RPM / °C

Odometer
 Display range: 0~99999 km (mile)
 reset automatically after 99999 km (mile)
 Display unit: 0.1 km (mile)

Trip A, B
 Display range: 0~999.9 km (mile)
 reset automatically after 0~999.9 km (mile)
 Display unit: 0.1 km (mile)