

Honda GROM[®] parts



KOSO

NORTH AMERICA



Fluid-technic



Programmable temperature tester



Tensility tester



Circuit-board plotter



Board plotter tester



3D Printer

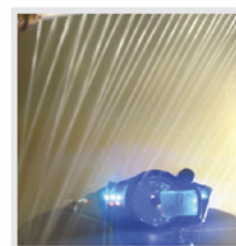

Water spray tester



Programmable salt spray tester

KOSO is synonym of quality and performance for more than 30 years ! Designing and manufacturing high quality products, **KOSO** is well known in the motorcycle, snowmobile, ATV and scooter industries. In fact, its good reputation for reliability and innovation capability made **KOSO** a source for many major OEM companies. Whether **KOSO** manufactures a product under private label, OEM or aftermarket product, the quality always remain a priority. Bringing new technologies and innovative product is also part of **KOSO's** philosophy as well as always pushing the limit further.

For many years **KOSO** have the opportunity to work with the best team of engineers, testing equipments and production facilities. For these reasons, **KOSO** remains a leader in analog and digital technology. **KOSO** carries a wide range of quality gauges & accessories, heating equipment, LED indicators, mirrors and engine parts for your convenience. **KOSO** is proud to offer you its complete line of products for serious riders !

www.kasonorthamerica.com

Order line : 1 877 777-0604

Tech. line : 450 359-0604

Fax : 450 359-0849

For more information : info@koso-na.com

GEAR indicator

for Honda GROM®

Always wondering in which gear you're in? Avoid this question by using our plug & play Gear Indicator for Honda GROM®. Lightweight, compact, easy to use and to install, this meter will quickly tell you which gear you've selected. Its big digits and blue backlight makes it easy to read during day or night riding. Made to fit the Honda GROM® models, this meter is a great addition for serious riders.



ITEM NUMBER **KN002001**

Parts included

Specifications



- | | |
|-------------------------------|------------------------------------|
| › Gear | Display range: N, 1, 2, 3, 4, 5, 6 |
| › Effective voltage | DC 12V |
| › Effective temperature range | -10~ + 60°C (14 ~ 140°F) |
| › Meter standard | JIS D0203 |
| › Meter size | 37 x 51 x 17mm |
| › Meter weight | ±51g |

Dimensions

Packaging

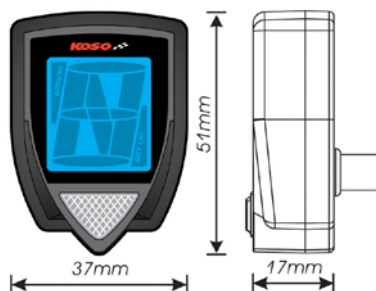

Optional bracket (not included)



ITEM NUMBER **BE007000**

MINI 3 cylinder head temp. meter for Honda GROM®

Need to monitor your engine temperature? Our Mini 3 meter is designed especially for Honda GROM® which is the perfect addition for you. Its peak recall function will allow you to see the maximum temperature reach.



ITEM NUMBER **BA003245**

Specifications

Temperature & Max. temp record	Display range : t-1 -20~200°C (-4~392°F) t-2 -40~185°C (-40~365°F) t-3 -20~220°C (~4~428°F) t-4 -20~200°C (~4~392°F) t-5 -20~120°C (~4~248°F)
	Display unit: 0.1°C (°F)
Temperature type	Display unit: t-1~t-5
Effective voltage	DC 12V
Effective temperature range	-10~60 °C (14 °F~140°F)
Meter standard	JIS D 0203 S2
Meter size (W X L X H)	W60 x L30 x H11.5 mm
Meter weight	±22g

Dimensions

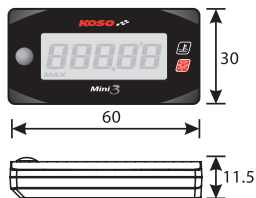

Optional top clamp (not included)

See page 5 for more details.



Parts included



Packaging



MINI 3 air/fuel ratio meter for Honda GROM®

Our Air/Fuel ratio gauge is designed to assist you to tune properly your engine and help you avoid engine problems. Just connect the meter to the 12 v DC power source and plug it to your OEM oxygen sensor and you're ready to go !



ITEM NUMBER **BA003214**

Specifications

A/F ratio	Display range: 12.2~17.2 Display unit: 0.1 If the A/F ratio is higher than 17.2, display will show -L- If the A/F ratio is lower than 12.2, display will show -A-
Effective voltage	DC 12V
Effective temperature range	-10~60°C
Meter standard	JIS D 0203 S2
Meter size (W X L X H)	60 x 30 x 11.5 mm
Meter weight	±22g

Dimensions

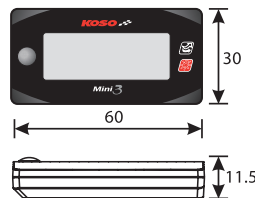

Optional top clamp (not included)

See page 5 for more details.



Parts included



Packaging



DB-03R digital LCD meter

plug & play for Honda GROM®

This plug & play DB-03R is the perfect addition for your Honda GROM®. Its changeable blue, orange or purple backlight makes it very easy to read at night even at high speed. The integrated indicator lights provide all the necessary information for any street use. The RPM scale is perfect for the Honda GROM® engine. This instrument also features a gear indicator and shift light which will allow you to shift in the perfect gear. Beside those great functions, the DB-03R features : speed, odometer, trip meter, RPM, temperature, volt, fuel level and a lot more ! Using the OEM sensors, this gauge is very easy to install.



ITEM NUMBER **BA038900**



Three colors changeable backlight

Parts included



Dimensions

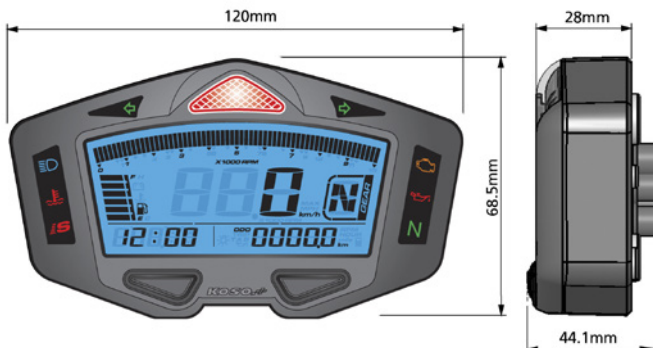

Packaging



Specifications

› Speedometer	Display range: 0~360 km/h (0~225 MPH) Display unit: km/h or MPH
› Display internal	<0.5 second
› Odometer	Display range: 0~99999 km (mile) Reset automatically after 99999 km (mile). Setting unit : 100 RPM
› Trip meter A/B	Display range: 0~999.9 km (mile) Reset automatically after 999.9 km (mile). Display unit: 0.1 km (mile).
› Total hour meter	Display range: 0~99999 H. Display unit: 1 H.
› Hour meter A.B	Display range: 0.0~999.9 H. Display unit: 0.1 H.
› Tire circumference	Setting range: 300~2,500 mm Setting unit: 1 mm, Sensitive point: 1~20
› Tachometer	Display range: 0~10,000 / 0~12,000 / 0~15,000 RPM. Display unit: 10,000 RPM-Each level represent 166 RPM, 12,000 RPM-Each level represent 200 RPM, 15,000 RPM-Each level represent 250 RPM
› Display internal	<0.5 second
› The RPM Red, Yellow	Setting range: 1,000~15,000 RPM
› Shift light	Setting unit: 100 RPM
› Warning	Light on (F-OFF) Flash (F-ON)
› MAX RPM record	Display range: 0~10,000 / 0~12,000 / 0~15,000 RPM
› The RPM input signal number setting	Setting range 0.5, 1~24
› The RPM input pulse	Setting range: HI (The positive wave pulse) Lo (The negative wave pulse)
› Temperature unit	Display unit: °C or °F
› Thermometer	Display range: 0.0~250.0°C (32.0~482.0°F) Display unit: 0.1°C (°F)
› Display internal	<0.5 second
› Over temp warning	Setting range: 60~250°C (140~482°F)
› Water temperature	Setting unit: 1°C (°F)
› Top temperature record	Display range: 0~250°C (32~482°F)
› Fuel meter	Display range: 6 levels Display unit: Each level represent 16.6 % Setting range: 100Ω, 250Ω, 510Ω, 1200Ω, SW
› Clock	24 H
› Volt meter	Display range: DC 8~18 V. Flashing warning when Voltage lower than 11.5 V or higher than 15.5 v.
› Backlight brightness	Setting range: 1-5 (Darkest)~5-5 (Brightest) Right Display unit: Each level represents 20 %
› Backlight color	Setting range: blue, orange, light purple
› Effective voltage	DC 12V
› Effective temperature range	-10~+60°C (14~+140°F)
› Meter standard	JIS D 0203 S2
› Meter size	120 X 68.5 X 44.1 mm
› Meter weight	±127g
› Indicator light color	Neutral-green, High beam-blue, Turn signal-green, EOBD-amber, Oil-red, Temperature alarm-red, RPM shift light (Red, Yellow)
› Sensor type	Passive speed sensor : BF019J06 Temperature sensor : BF030000
› Gear Meter	Display range : N, 1, 2, 3, 4, 5, 6, 7, 8, 9,

TOP CLAMP

for Honda GROM®

This useful Top clamp bracket for Honda GROM® will help you get a clean look even with an additional meter installed. Whether you choose one of our plug-in gauges for Honda GROM® or one of our Mini 3 series, this Top clamp is the perfect complement !

ITEM NUMBER **BE030100**

SILVER

ITEM NUMBER **BE030000**

RED

ITEM NUMBER **BE030200**

BLACK

Dimensions

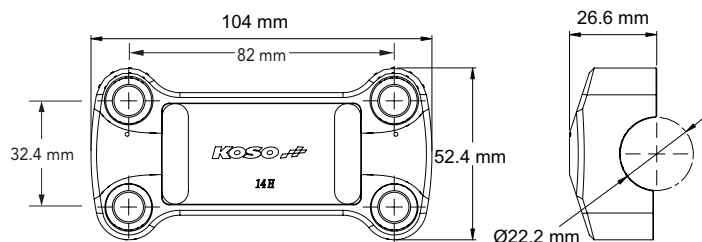

Product compatibility

Plug & play meters for Honda GROM® (not included) :

BA003214	Mini 3 cylinder head temp. meter for Honda GROM®	See page 2
BA003245	Mini 3 air/fuel ratio meter for Honda GROM®	See page 2

Universal meters (not included) :

BA003190	Mini 3 amp & volt meter
BA003160	Mini 3 clock & volt meter
BA003170	Mini 3 dual temperature
BA003130	Mini 3 ambient temperature/clock/volt meter
BA003200	Mini 3 oil pressure meter
BA003211	Mini 3 air/fuel ratio meter
BA003250	Mini 3 fuel meter
BA003270	Mini 3 ambient temperature meter

Packaging



BIG BORE kit 170cc

for Honda GROM®

Want to unleash all the power your Honda GROM® can handle? Our 170cc Big Bore kit is the perfect addition for you! The kit includes a ceramic coated cylinder, 61 mm forged piston, rings, pin, gasket kit and banjo bolts. Its compression ratio of 11.5 to 1 will allow you to still use premium pump gas and keep the reliability of a stock motor. Made from the best components available on the market, our 170cc big bore kit will amaze you !



ITEM NUMBER **MB623002**

Test diagram

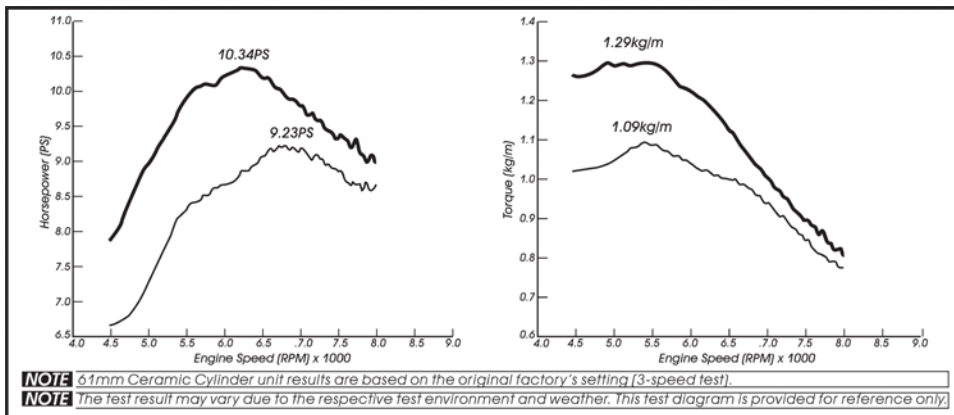

Packaging



BIG BORE KIT

Parts included

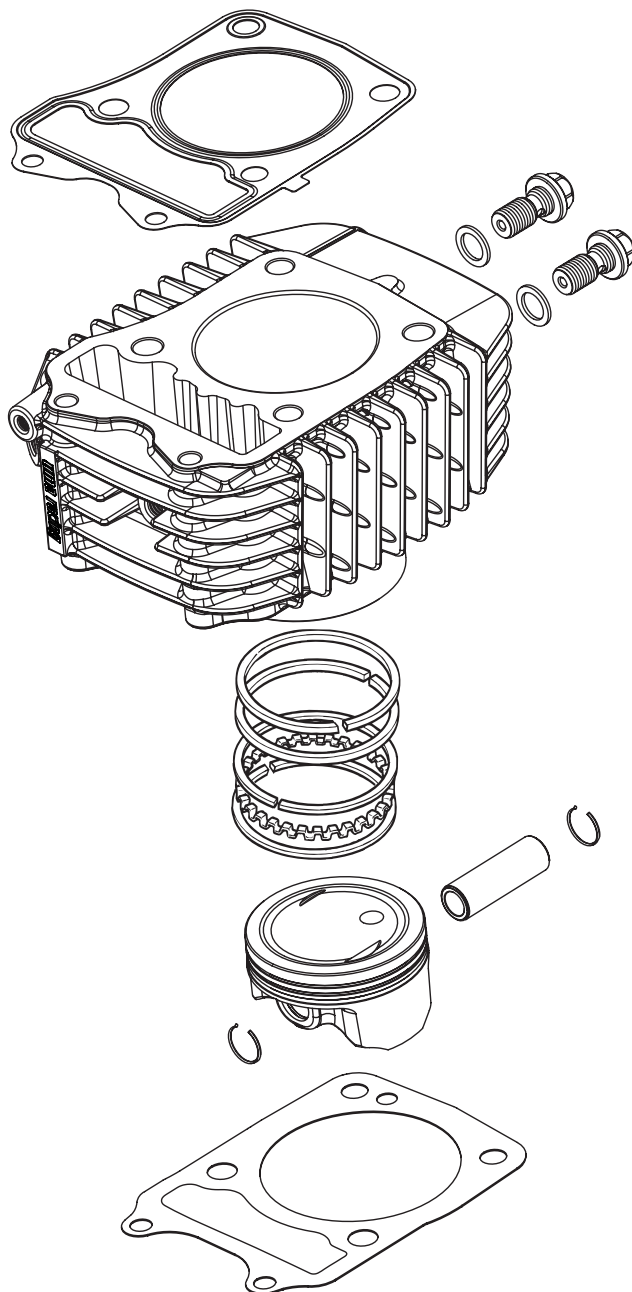
Assembly**CERAMIC COATED CYLINDER****GASKET KIT**ITEM NUMBER **MA623100****PISTON KIT****Specifications**

- | | |
|---------------------|-----------|
| › Piston size | 61 mm |
| › Piston type | Forged |
| › Compression ratio | 11.5 to 1 |

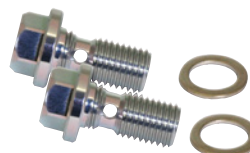
ITEM NUMBER **MD623000****BANJO BOLTS KIT**ITEM NUMBER **MO623100****Optional camshaft (not included)**

See page 8 for more details.

Specifications

- | | |
|-------------------------|---------------------------|
| › Cylinder displacement | 169.2 cc |
| › Cylinder material | Aluminum / ceramic coated |
| › Piston size | 61 mm |
| › Piston type | Forged |
| › Compression ratio | 11.5 to 1 |

CAMSHAFT kit

for Honda GROM®

Our 240 degrees performance camshaft will give you great results at high RPM. This camshaft can be used with a stock engine, but will even give better results with the Koso 170cc big bore kit.

Made from quality material for longer durability, the Koso GROM camshaft is a clever choice.

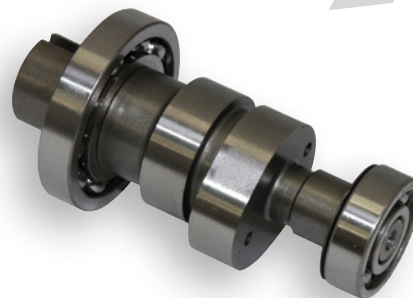

ITEM NUMBER **MM623002**

Assembly

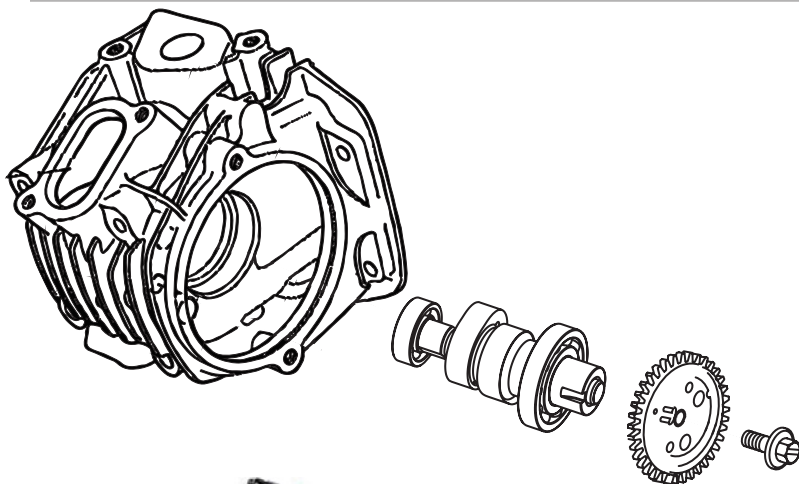

Torque test

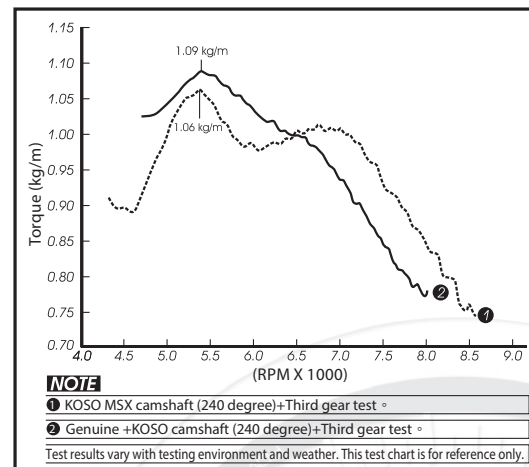

Packaging



HURRICANE racing air filter

for Honda GROM®

Want better performance with a simple change? Using the Hurricane multi air filter intake will increase the airflow, improve filtering efficiency and raise the engine output performance.

This high-quality foam filter is easy to assemble and disassemble and suitable for long-term use with repetitive cleaning.



ITEM NUMBER **DK623000**

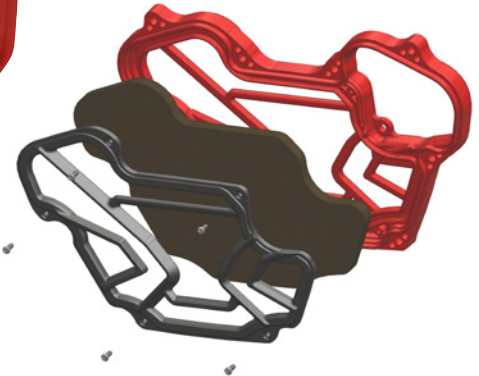

CONNECTING tube

for Honda GROM®

Our air box connecting tube has been developed to link the Koso's 34 mm Throttle body and the actual air box.



ITEM NUMBER **DM623000**

RUBBER intake

for Honda GROM®

The main function of this intake is to meet the demand of a larger cylinder and therefore improve air intake volume for a better efficiency.



ITEM NUMBER **DM623K10**

As the throttle body and intake manifold are used to control the amount of air flowing to the engine's combustion chamber, they are important elements of the admission system. Using our Koso's 34 mm throttle body in conjunction with our 30.5 to 34mm intake manifold will allow a better air/fuel mixtures for a quicker throttle response.

THROTTLE body

for Honda GROM®



ITEM NUMBER **DY623013**

Parts included



Packaging



INTAKE manifold

for Honda GROM®



ITEM NUMBER **DP623001**

Parts included



Packaging





Quality Products
SINCE



Feel the speed

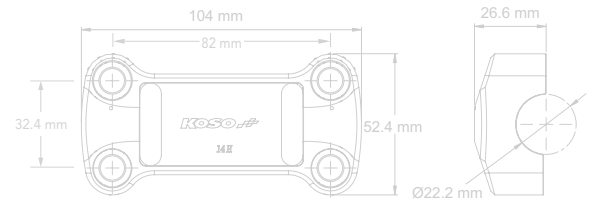
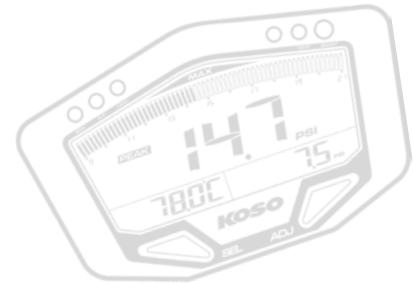
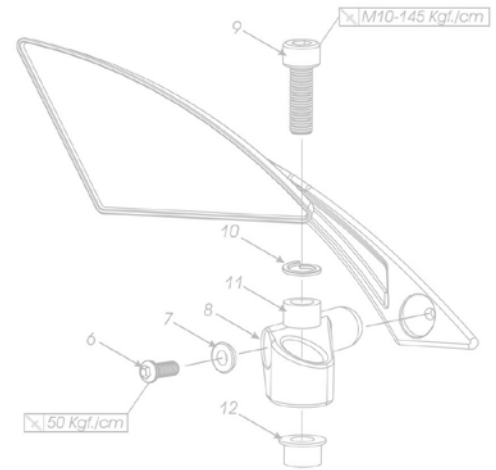
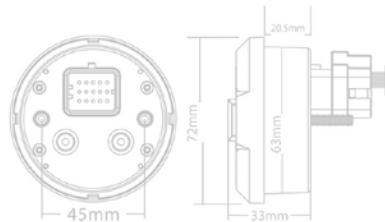
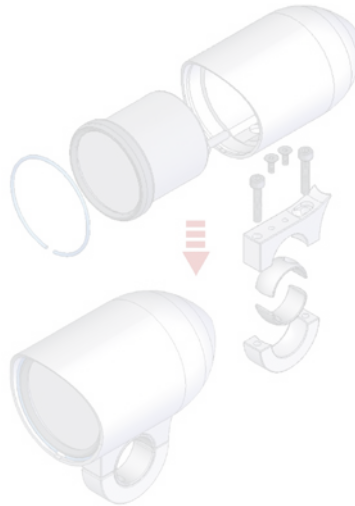
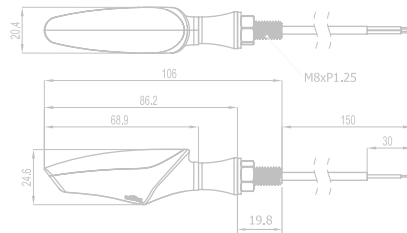
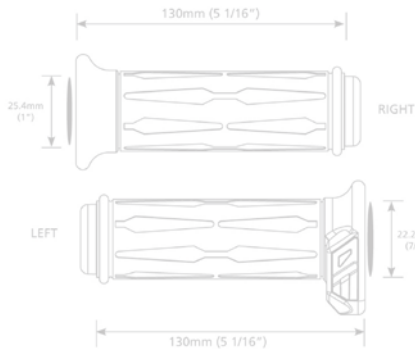
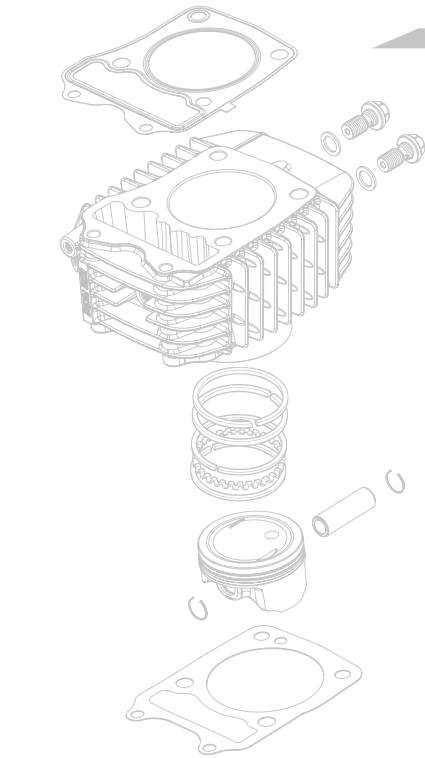

www.kosonorthamerica.com
 Order line : 1 877 777-0604
 Tech. line : 450 359-0604
 Fax : 450 359-0849
 For more information : info@koso-na.com